

Meeting	LICENSING SUB COMMITTEE
Time/Day/Date	10.30 am on Tuesday, 28 September 2021
Location	Council Chamber, Council Offices, Coalville
Officer to contact	Democratic Services (01530 454512) (01530 454512) Licensing Enforcement Officer (01530 454596)

NOTIFICATION OF HEARING

Item		Pages
1	ELECTION OF CHAIRMAN	
2	APOLOGIES FOR ABSENCE	
3	DECLARATION OF INTERESTS	
	Under the Code of Conduct members are reminded that in declaring disclosable interests you should make clear the nature of that interest and whether it is pecuniary or non-pecuniary.	
4	APPLICATION FOR A PREMISES LICENCE	
	PREMISES: The Spar, Delven Lane, Castle Donington, Derby, LE65 2LJ	3 - 48
	APPLICANT: Liluben Odedra	
	To determine an application for a premises licence in respect of the above.	
	Representations have been received from 3 members of the public, 2 of which were rejected. A Notice of Hearing inviting them to attend has been sent. If they fail to attend, the hearing can be held in their absence or adjourned.	
	The following documents are attached: -	
	a) Report of the Licensing Enforcement Officer	
	At the beginning of the Hearing, the authority shall explain to the parties the procedure it is proposed to follow. The Hearing shall take the form of a discussion led by the authority and cross-examination shall not be permitted unless it is required to consider the representations.	

Circulation:

Councillor J Clarke

Councillor G Hout (Reserve Member)

Councillor R L Morris

Councillor S Sheahan

NORTH WEST LEICESTERSHIRE DISTRICT COUNCIL

LICENSING SUB COMMITTEE – 28 September 2021



Title of Report	APPLICATION FOR A GRANT OF PREMISES LICENCE	
Presented by	Paul Dennis Licensing Enforcement Officer	
Background Papers	Revised Guidance issued under Section 182 of the Licensing Act 2003 Statement of Licensing Policy – Issue 7	Public Report: Yes
Purpose of Report	<p>To determine an application for a grant of a premises licence in respect of the premises The Spar, Delven Lane, Castle Donington, Derby, LE65 2LJ.</p> <p>This report outlines the application and also highlights the licensing objectives, the relevant parts of Government guidance and the pertinent sections of the Licensing Authority's Licensing Policy.</p>	
Recommendations	THAT THE SUB-COMMITTEE DETERMINE THE APPLICATION.	

1. Background

- 1.1. On 3 August 2021, Liluben Odedra submitted an application for a premises licence grant at The Spar, Delven Lane, Castle Donington, Derby DE74 2LJ. A copy of the application is presented as **Appendix 1**. A plan of the premises is presented as **Appendix 2**.
- 1.2. An aerial view of the site is presented as **Appendix 3** and a map is presented as **Appendix 4**.

- 1.3. The application identifies that if the premises licence variation is granted, the following opening hours and licensable activities will occur.

Opening Hours	Timings	
	Everyday	07:00 hours - 22:00 hours
Licensable activity	Timings	
Supply by retail of alcohol	Everyday	07:00 hours - 22:00 hours

- 1.4. As part of the application, the applicant has specified the steps they intend to take in order to promote the four licensing objectives. These are as follows:-

- **General**

All licensing objectives will be met and the business will undertake all responsibilities under the Licence Act 2003.

- **The prevention of crime and disorder**

28 days cctv recording to be kept and can be viewed by officers.
Posters of Challenge 25 and 'no id no sale' will be displayed throughout the shop.
Staff will be trained appropriately.
Refusals log register will be kept.

- **Public safety**

All due diligence to be kept when keeping customers safe from harm. Floors will be clear from hazards.

- **The prevention of public nuisance**

Refuse collection will be between 07:00 and 18:00.

- **The protection of children from harm**

Children under 18 will not be allowed to purchase alcohol.
Third party sales will not be permitted.
'No id no sale' poster will be on display at point of purchase.

- 1.5 The premises are not currently trading and therefore the licensing authority have not received any complaints in relation to the premises.

2 Representations

- 2.1. In respect of an application for the grant of a premises licence, the applicant is responsible for advertising the application by way of a notice in specified form at the premises for not less than 28 consecutive days and in a local newspaper. The applicant placed a notice in the Loughborough Echo on Wednesday 11 August 2021 and officers are satisfied that the correct notices have been displayed at the premises.
- 2.2 Each of the responsible authorities have been served a copy of the application, namely; the Police, Fire Authorities, Home Office, Trading Standards Department, the District Council's Health and Safety, Environmental Protection, Public Health Authority and Planning Sections. We have received no representations from the responsible authorities.
- 2.3 One relevant representation has been received from a member of the public on the grounds of prevention of crime and disorder, prevention of public nuisance and public safety. This representation is presented as **Appendix 5**.
- 2.4 Two further representations were received from members of the public which were deemed to be "irrelevant" and were rejected. These representations are presented as **Appendices 6 - 8**. The acknowledgement and rejection letters are presented as **Appendices 9 and 10**.

3. Statutory Guidance

- 3.1 In making its decision, the Sub-Committee is obliged to have regard to Guidance issued by the Secretary of State under Section 182 of the Licensing Act 2003. All Licensing Committee members have been provided with a full copy of the guidance document. Officers consider that paragraphs 1.1 to 1.5, 1.13 to 1.17, 2.1 to 2.6, 2.7 to 2.9, 2.15 to 2.21, 2.22 to 2.31, 3.1 to 3.2, 8.13 to 8.14, 8.34, 8.41 to 8.49, 8.80 to 8.87, 9.1, 9.3 to 9.9, 9.31 to 9.44, 10.1 to 10.10, 10.13 to 10.15, 13.10, 14.1 to 14.3, may have a bearing upon the application.

4. Statement of Licensing Policy

- 4.1 The Sub-Committee is also obliged to have regard to its own Statement of Licensing Policy. Officers consider that paragraphs 2.1 to 2.5, 3.0, 4.1 to 4.4, 5.1 to 5.4, 6.1 to 6.4, 7.1 to 7.4, 11.0, 19.2, 22.0, 23.0, and 26.0 may have a bearing upon the application.

5. Observations

- 5.1 The Committee is obliged to determine this application with a view to promoting the licensing objectives, which are:
 - a. The prevention of crime and disorder;
 - b. Public safety;
 - c. The prevention of public nuisance;
 - d. The protection of children from harm.

5.2 The Committee may take such of the following steps, if any, as it considers appropriate for the promotion of the licensing objectives:

- Grant the application and issue the premises licence as requested.
- Modify the conditions of the licence, by altering or omitting or adding to them.
- Reject the whole or part of the application.

5.3 There is a right of appeal to the Magistrates' Court against the decision of the Sub-Committee by the applicant and persons who made relevant representations.

Policies and other considerations, as appropriate	
Council Priorities:	Business and Jobs, Homes and Communities
Policy Considerations:	Statement of Licensing Policy – Issue 7
Safeguarding:	To determine the application in accordance with the Licensing Act 2003 objectives
Equalities/Diversity:	Equality Impact Assessment already undertaken, issues identified actioned
Customer Impact:	Not applicable
Economic and Social Impact:	Customers may be impacted by any decision made
Environment and Climate Change:	Not applicable
Consultation/Community Engagement:	Leicestershire Police, Leicestershire Fire and Rescue Service, The Home Office, Trading Standards, Health and Safety, Environmental Protection, Licensing Authority, Planning, Health Authority and members of the public/local businesses by way of notice at the premises, in a local newspaper, on the Council's website and at the Council Offices, Coalville.
Risks:	The risk of incurring costs arising from an appeal against the decision of the Committee. In any event and in order to mitigate these risks, the Committee should give clear reasons for its decisions and any such reasons would need to be substantiated in Court.
Officer Contact	Paul Dennis Licensing Enforcement Officer paul.dennis@nwleicestershire.gov.uk



Application for a Premises Licence to be Granted Under the Licensing Act 2003

PLEASE READ THE FOLLOWING INSTRUCTIONS FIRST

Before completing this form please read the guidance notes at the end of the form. If you are completing this form by hand please write legibly in block capitals. In all cases ensure that your answers are inside the boxes and written in black ink. Use additional sheets if necessary.

You may wish to keep a copy of the completed form for your records.

I/We LILUBEN ODEDRA

(Insert name(s) of applicant)

apply for a premises licence under section 17 of the Licensing Act 2003 for the premises described in Part 1 below (the premises) and I/we are making this application to you as the relevant licensing authority in accordance with section 12 of the Licensing Act 2003

Part 1 – Premises details

Postal address of premises or, if none, ordnance survey map reference or description			
DELVEN LANE ,CASTLE DONNINGTON ,DERBY ,DE74 2LJ			
Post town	DERBY	Postcode	DE74 2LJ

Telephone number at premises (if any)	
Non-domestic rateable value of premises	£0

Part 2 - Applicant details

Please state whether you are applying for a premises licence as Please tick as appropriate

a) an individual or individuals *

☒ please complete section (A)

Type text here

- b) a person other than an individual *
- i as a limited company/limited liability partnership ☐ please complete section (B)
 - ii as a partnership (other than limited liability) ☐ please complete section (B)
 - iii as an unincorporated association or ☐ please complete section (B)
 - iv other (for example a statutory corporation) ☐ please complete section (B)
- c) a recognised club ☐ please complete section (B)
- d) a charity ☐ please complete section (B)
- e) the proprietor of an educational establishment ☐ please complete section (B)
- f) a health service body ☐ please complete section (B)
- g) a person who is registered under Part 2 of the Care Standards Act 2000 (c14) in respect of an independent hospital in Wales ☐ please complete section (B)
- ga) a person who is registered under Chapter 2 of Part 1 of the Health and Social Care Act 2008 (within the meaning of that Part) in an independent hospital in England ☐ please complete section (B)
- h) the chief officer of police of a police force in England and Wales ☐ please complete section (B)

* If you are applying as a person described in (a) or (b) please confirm (by ticking yes to one box below):

I am carrying on or proposing to carry on a business which involves the use of the premises for licensable activities; or ☒

I am making the application pursuant to a

statutory function or ☐

a function discharged by virtue of Her Majesty's prerogative ☐

(A) INDIVIDUAL APPLICANTS (fill in as applicable)

Mr <input type="checkbox"/>	Mrs <input checked="" type="checkbox"/>	Miss <input type="checkbox"/>	Ms <input type="checkbox"/>	Other Title (for example, Rev)	
Surname ODEDRA			First names LILUBEN		
Date of birth over		I am 18 years old or		<input checked="" type="checkbox"/> Please tick yes	
Nationality BRITISH					
Current residential address if different from premises address					

Post town		Postcode	
Daytime contact telephone number			
E-mail address (optional)			

SECOND INDIVIDUAL APPLICANT (if applicable)

Mr <input type="checkbox"/>	Mrs <input type="checkbox"/>	Miss <input type="checkbox"/>	Ms <input type="checkbox"/>	Other Title (for example, Rev)	
Surname			First names		
Date of birth over		I am 18 years old or		<input type="checkbox"/>	Please tick yes
Nationality					
Current postal address if different from premises address					
Post town		Postcode			
Daytime contact telephone number					
E-mail address (optional)					

(B) OTHER APPLICANTS

Please provide name and registered address of applicant in full. Where appropriate please give any registered number. In the case of a partnership or other joint venture (other than a body corporate), please give the name and address of each party concerned.

Name
Address
Registered number (where applicable)

Description of applicant (for example, partnership, company, unincorporated association etc.)
Telephone number (if any)
E-mail address (optional)

Part 3 Operating Schedule

When do you want the premises licence to start?

DD	MM	YYYY
3	1	0 8 2 0 2 1

If you wish the licence to be valid only for a limited period, when do you want it to end?

DD	MM	YYYY

Please give a general description of the premises (please read guidance note 1)

THIS BUILDING IS PROPOSING TO BE USED A GROCERY CONVENIENCE STORE
TO OPEN MONDAY TO SUNDAY , 07:00 AM TO 10PM

If 5,000 or more people are expected to attend the premises at any one time, please state the number expected to attend.

What licensable activities do you intend to carry on from the premises?

(please see sections 1 and 14 and Schedules 1 and 2 to the Licensing Act 2003)

Provision of regulated entertainment (please read guidance note 2)

Please tick all that apply

- a) plays (if ticking yes, fill in box A) ☐
- b) films (if ticking yes, fill in box B) ☐
- c) indoor sporting events (if ticking yes, fill in box C) ☐
- d) boxing or wrestling entertainment (if ticking yes, fill in box D) ☐
- e) live music (if ticking yes, fill in box E) ☐

- f) recorded music (if ticking yes, fill in box F) ☐
- g) performances of dance (if ticking yes, fill in box G) ☐
- h) anything of a similar description to that falling within (e), (f) or (g)
(if ticking yes, fill in box H) ☐

Provision of late night refreshment (if ticking yes, fill in box I) ☐

Supply of alcohol (if ticking yes, fill in box J) ☒

In all cases complete boxes K, L and M

A

Plays Standard days and timings (please read guidance note 7)			<u>Will the performance of a play take place indoors or outdoors or both – please tick</u> (please read guidance note 3)	Indoors	<input type="checkbox"/>
				Outdoors	<input type="checkbox"/>
				Both	<input type="checkbox"/>
Day	Start	Finish			
Mon			<u>Please give further details here</u> (please read guidance note 4)		
Tue					
Wed			<u>State any seasonal variations for performing plays</u> (please read guidance note 5)		
Thur					
Fri			<u>Non standard timings. Where you intend to use the premises for the performance of plays at different times to those listed in the column on the left, please list</u> (please read guidance note 6)		
Sat					
Sun					

B

Films Standard days and timings (please read guidance note 7)			Will the exhibition of films take place indoors or outdoors or both – please tick (please read guidance note 3)	Indoors	<input type="checkbox"/>
				Outdoors	<input type="checkbox"/>
				Both	<input type="checkbox"/>
Day	Start	Finish			
Mon			Please give further details here (please read guidance note 4)		
Tue					
Wed			State any seasonal variations for the exhibition of films (please read guidance note 5)		
Thur					
Fri			Non standard timings. Where you intend to use the premises for the exhibition of films at different times to those listed in the column on the left, please list (please read guidance note 6)		
Sat					
Sun					

C

Indoor sporting events Standard days and timings (please read guidance note 7)			<u>Please give further details</u> (please read guidance note 4)
Day	Start	Finish	
Mon			
Tue			<u>State any seasonal variations for indoor sporting events</u> (please read guidance note 5)
Wed			
Thur			<u>Non standard timings. Where you intend to use the premises for indoor sporting events at different times to those listed in the column on the left, please list</u> (please read guidance note 6)
Fri			
Sat			
Sun			

LILUBEN ODEDRA

D

Boxing or wrestling entertainments Standard days and timings (please read guidance note 7)			<u>Will the boxing or wrestling entertainment take place indoors or outdoors or both – please tick</u> (please read guidance note 3)	Indoors	<input type="checkbox"/>
				Outdoors	<input type="checkbox"/>
				Both	<input type="checkbox"/>
Day	Start	Finish			
Mon			<u>Please give further details here</u> (please read guidance note 4)		
Tue					
Wed			<u>State any seasonal variations for boxing or wrestling entertainment</u> (please read guidance note 5)		
Thur					
Fri			<u>Non standard timings. Where you intend to use the premises for boxing or wrestling entertainment at different times to those listed in the column on the left, please list</u> (please read guidance note 6)		
Sat					
Sun					

E

Live music Standard days and timings (please read guidance note 7)			Will the performance of live music take place indoors or outdoors or both – please tick (please read guidance note 3)	Indoors	<input type="checkbox"/>
				Outdoors	<input type="checkbox"/>
				Both	<input type="checkbox"/>
Day	Start	Finish			
Mon			Please give further details here (please read guidance note 4)		
Tue					
Wed			State any seasonal variations for the performance of live music (please read guidance note 5)		
Thur					
Fri			Non standard timings. Where you intend to use the premises for the performance of live music at different times to those listed in the column on the left, please list (please read guidance note 6)		
Sat					
Sun					

F

Recorded music Standard days and timings (please read guidance note 7)			<u>Will the playing of recorded music take place indoors or outdoors or both – please tick</u> (please read guidance note 3)	Indoors	<input type="checkbox"/>
				Outdoors	<input type="checkbox"/>
				Both	<input type="checkbox"/>
Day	Start	Finish	<u>Please give further details here</u> (please read guidance note 4)		
Mon					
Tue					
			<u>State any seasonal variations for the playing of recorded music</u> (please read guidance note 5)		
Wed					
Thur					
			<u>Non standard timings. Where you intend to use the premises for the playing of recorded music at different times to those listed in the column on the left, please list</u> (please read guidance note 6)		
Fri					
Sat					
Sun					

G

Performances of dance Standard days and timings (please read guidance note 7)			<u>Will the performance of dance take place indoors or outdoors or both – please tick</u> (please read guidance note 3)	Indoors	<input type="checkbox"/>
				Outdoors	<input type="checkbox"/>
Day	Start	Finish		Both	<input type="checkbox"/>
Mon			<u>Please give further details here</u> (please read guidance note 4)		
Tue					
Wed			<u>State any seasonal variations for the performance of dance</u> (please read guidance note 5)		
Thur					
Fri			<u>Non standard timings. Where you intend to use the premises for the performance of dance at different times to those listed in the column on the left, please list</u> (please read guidance note 6)		
Sat					
Sun					

H

Anything of a similar description to that falling within (e), (f) or (g) Standard days and timings (please read guidance note 7)			Please give a description of the type of entertainment you will be providing		
Day	Start	Finish	<u>Will this entertainment take place indoors or outdoors or both – please tick</u> (please read guidance note 3)	Indoors	<input type="checkbox"/>
Mon				Outdoors	<input type="checkbox"/>
				Both	<input type="checkbox"/>
Tue			<u>Please give further details here</u> (please read guidance note 4)		
Wed					
			<u>State any seasonal variations for entertainment of a similar description to that falling within (e), (f) or (g)</u> (please read guidance note 5)		
Thur					
Fri			<u>Non standard timings. Where you intend to use the premises for the entertainment of a similar description to that falling within (e), (f) or (g) at different times to those listed in the column on the left, please list</u> (please read guidance note 6)		
Sat					
Sun					

I

Late night refreshment Standard days and timings (please read guidance note 7)			Will the provision of late night refreshment take place indoors or outdoors or both – please tick (please read guidance note 3)	
			Indoors	<input type="checkbox"/>
			Outdoors	<input type="checkbox"/>
			Both	<input type="checkbox"/>
Day	Start	Finish	Please give further details here (please read guidance note 4)	
Mon				
Tue				
			State any seasonal variations for the provision of late night refreshment (please read guidance note 5)	
Wed				
Thur				
			Non standard timings. Where you intend to use the premises for the provision of late night refreshment at different times, to those listed in the column on the left, please list (please read guidance note 6)	
Fri				
Sat				
Sun				

J

Supply of alcohol Standard days and timings (please read guidance note 7)			Will the supply of alcohol be for consumption – please tick (please read guidance note 8)	On the premises	<input type="checkbox"/>
				Off the premises	<input checked="" type="checkbox"/>
				Both	<input type="checkbox"/>
Day	Start	Finish	State any seasonal variations for the supply of alcohol (please read guidance note 5)		
Mon	07:00	22:00			
Tue	07:00	22:00			
Wed	07:00	22:00			
Thur	07:00	22:00	Non standard timings. Where you intend to use the premises for the supply of alcohol at different times to those listed in the column on the left, please list (please read guidance note 6)		
Fri	07:00	22:00			
Sat	07:00	22:00			
Sun	07:00	22:00			

State the name and details of the individual whom you wish to specify on the licence as designated premises supervisor (Please see declaration about the entitlement to work in the checklist at the end of the form):

Name	LILUBEN ODEDRA
Date of birth	[REDACTED]
Address	[REDACTED]
Postcode	[REDACTED]
Personal licence number (if known)	LEIPRS 4505
Issuing licensing authority (if known)	LEICESTER CITY COUNCIL

☐ ☐ ☐ ☐

KType text here

Please highlight any adult entertainment or services, activities, other entertainment or matters ancillary to the use of the premises that may give rise to concern in respect of children (please read guidance note 9).
NONE

L

Hours premises are open to the public Standard days and timings (please read guidance note 7)			<u>State any seasonal variations</u> (please read guidance note 5)
Day	Start	Finish	<u>Non standard timings. Where you intend the premises to be open to the public at different times from those listed in the column on the left, please list</u> (please read guidance note 6)
Mon	07:00	22:00	
Tue	07:00	22:00	
Wed	07:00	22:00	
Thur	07:00	22:00	
Fri	07:00	22:00	
Sat	07:00	22:00	
Sun	07:00	22:00	

M Describe the steps you intend to take to promote the four licensing objectives:

a) General – all four licensing objectives (b, c, d and e) (please read guidance note 10)

ALL LICENSING OBJECTIVES WILL BE MET AND THE BUSINESS WILL UNDERTAKE
ALL RESPONSIBILITIES UNDER THE LICENCE ACT 2003

b) The prevention of crime and disorder

28 DAYS CCTV RECORDING TO BE KEPT AND CAN BE VIEW BY OFFICERS
POSTERS OF CHALLENGE 25 AND NO ID NO SALE WILL BE DISPLAYED THROUGHOUT
THE SHOP.

STAFF WILL BE TRAINED APPROPRIATELY
LOG REGISTER WILL BE KEPT

c) Public safety

ALL DUE DILIGENCE TO BE KEPT WHEN KEEPING CUSTOMERS
SAFE FROM HARM. FLOORS WILL BE CLEAR FROM HAZARDS

d) The prevention of public nuisance

REFUSE COLLECTION WILL BE BETWEEN 07:00 TO 18:00 Type text here

e) The protection of children from harm

CHILDREN UNDER 18 WILL NOT BE ALLOWED TO PURCHASE ALCOHOL
THIRD PARTY SALES WILL NOT BE PERMITTED
NO ID NO POSTER WILL BE ON DISPLAY AT POINT OF PURCHASE

Checklist:

Please tick to indicate agreement

- I have made or enclosed payment of the fee. ☒
- I have enclosed the plan of the premises. ☒
- I have sent copies of this application and the plan to responsible authorities and others where applicable. ☒
- I have enclosed the consent form completed by the individual I wish to be designated premises supervisor, if applicable. ☒
- I understand that I must now advertise my application. ☒
- I understand that if I do not comply with the above requirements my application will be rejected. ☒
- ☐
[Applicable to all individual applicants, including those in a partnership which is not a limited liability partnership, but not companies or limited liability partnerships] I have included documents demonstrating my entitlement to work in the United Kingdom (please read note 15). ☒

IT IS AN OFFENCE, UNDER SECTION 158 OF THE LICENSING ACT 2003, TO MAKE A FALSE STATEMENT IN OR IN CONNECTION WITH THIS APPLICATION. THOSE WHO MAKE A FALSE STATEMENT MAY BE LIABLE ON SUMMARY CONVICTION TO A FINE OF ANY AMOUNT.

IT IS AN OFFENCE UNDER SECTION 24B OF THE IMMIGRATION ACT 1971 FOR A PERSON TO WORK WHEN THEY KNOW, OR HAVE REASONABLE CAUSE TO BELIEVE, THAT THEY ARE DISQUALIFIED FROM DOING SO BY REASON OF THEIR IMMIGRATION STATUS. THOSE WHO EMPLOY AN ADULT WITHOUT LEAVE OR WHO IS SUBJECT TO CONDITIONS AS TO EMPLOYMENT WILL BE LIABLE TO A CIVIL PENALTY UNDER SECTION 15 OF THE IMMIGRATION, ASYLUM AND NATIONALITY ACT 2006 AND PURSUANT TO SECTION 21 OF THE SAME ACT, WILL BE COMMITTING AN OFFENCE WHERE THEY DO SO IN THE KNOWLEDGE, OR WITH REASONABLE CAUSE TO BELIEVE, THAT THE EMPLOYEE IS DISQUALIFIED.

Part 4 – Signatures (please read guidance note 11)

Signature of applicant or applicant's solicitor or other duly authorised agent (see guidance note 12). **If signing on behalf of the applicant, please state in what capacity.**

Declaration	<ul style="list-style-type: none"> [Applicable to individual applicants only, including those in a partnership which is not a limited liability partnership] I understand I am not entitled to be issued with a licence if I do not have the entitlement to live and work in the UK (or if I am subject to a condition preventing me from doing work relating to the carrying on of a licensable activity) and that my licence will become invalid if I cease to be entitled to live and work in the UK (please read guidance note 15). The DPS named in this application form is entitled to work in the UK (and is not subject to conditions preventing him or her from doing work relating to a licensable activity) and I have seen a copy of his or her proof of entitlement to work, if appropriate (please see note 15)
Signature	A Bhawsar
Date	02/08/2021
Capacity	LICENSING AGENTS -GREENHILL LICENCES

For joint applications, signature of 2nd applicant or 2nd applicant's solicitor or other authorised agent (please read guidance note 13). **If signing on behalf of the applicant, please state in what capacity.**

Signature	
Date	
Capacity	

Contact name (where not previously given) and postal address for correspondence associated with this application (please read guidance note 14)			
GREENHILL LICENCES 20 CRAIGHILL ROAD			
Post town	LEICESTER	Postcode	LE23FB
Telephone number (if any)			
If you would prefer us to correspond with you by e-mail, your e-mail address (optional) GREENHILL.LICENCES@HOTMAIL.COM			

Notes for Guidance

1. Describe the premises, for example the type of premises, its general situation and layout and any other information which could be relevant to the licensing objectives. Where your application includes off-supplies of alcohol and you intend to provide a place for consumption of these off-supplies, you must include a description of where the place will be and its proximity to the premises.
2. In terms of specific regulated entertainments please note that:

- Plays: no licence is required for performances between 08:00 and 23.00 on any day, provided that the audience does not exceed 500.
- Films: no licence is required for 'not-for-profit' film exhibition held in community premises between 08.00 and 23.00 on any day provided that the audience does not exceed 500 and the organiser (a) gets consent to the screening from a person who is responsible for the premises; and (b) ensures that each such screening abides by age classification ratings.
- Indoor sporting events: no licence is required for performances between 08.00 and 23.00 on any day, provided that the audience does not exceed 1000.
- Boxing or Wrestling Entertainment: no licence is required for a contest, exhibition or display of Greco-Roman wrestling, or freestyle wrestling between 08.00 and 23.00 on any day, provided that the audience does not exceed 1000. Combined fighting sports – defined as a contest, exhibition or display which combines boxing or wrestling with one or more martial arts – are licensable as a boxing or wrestling entertainment rather than an indoor sporting event.
- Live music: no licence permission is required for:
 - a performance of unamplified live music between 08.00 and 23.00 on any day, on any premises.
 - a performance of amplified live music between 08.00 and 23.00 on any day on premises authorised to sell alcohol for consumption on those premises, provided that the audience does not exceed 500.
 - a performance of amplified live music between 08.00 and 23.00 on any day, in a workplace that is not licensed to sell alcohol on those premises, provided that the audience does not exceed 500.
 - a performance of amplified live music between 08.00 and 23.00 on any day, in a church hall, village hall, community hall, or other similar community premises, that is not licensed by a premises licence to sell alcohol, provided that (a) the audience does not exceed 500, and (b) the organiser gets consent for the performance from a person who is responsible for the premises.
 - a performance of amplified live music between 08.00 and 23.00 on any day, at the non-residential premises of (i) a local authority, or (ii) a school, or (iii) a hospital, provided that (a) the audience does not exceed 500, and (b) the organiser gets consent for the performance on the relevant premises from: (i) the local authority concerned, or (ii) the school or (iii) the health care provider for the hospital.
- Recorded Music: no licence permission is required for:
 - any playing of recorded music between 08.00 and 23.00 on any day on premises authorised to sell alcohol for consumption on those premises, provided that the audience does not exceed 500.
 - any playing of recorded music between 08.00 and 23.00 on any day, in a church hall, village hall, community hall, or other similar community premises, that is not licensed by a premises licence to sell alcohol, provided that (a) the audience does not exceed 500, and (b) the organiser gets consent for the performance from a person who is responsible for the premises.
 - any playing of recorded music between 08.00 and 23.00 on any day, at the non-residential premises of (i) a local authority, or (ii) a school, or (iii) a hospital, provided that (a) the audience does not exceed 500, and (b) the organiser gets consent for the performance on the relevant premises from: (i) the local authority concerned, or (ii) the school proprietor or (iii) the health care provider for the hospital.
- Dance: no licence is required for performances between 08.00 and 23.00 on any day, provided that the audience does not exceed 500. However, a performance which amounts to adult entertainment remains licensable.

- Cross activity exemptions: no licence is required between 08.00 and 23.00 on any day, with no limit on audience size for:
 - any entertainment taking place on the premises of the local authority where the entertainment is provided by or on behalf of the local authority;
 - any entertainment taking place on the hospital premises of the health care provider where the entertainment is provided by or on behalf of the health care provider;
 - any entertainment taking place on the premises of the school where the entertainment is provided by or on behalf of the school proprietor; and
 - any entertainment (excluding films and a boxing or wrestling entertainment) taking place at a travelling circus, provided that (a) it takes place within a moveable structure that accommodates the audience, and (b) that the travelling circus has not been located on the same site for more than 28 consecutive days.
3. Where taking place in a building or other structure please tick as appropriate (indoors may include a tent).
 4. For example the type of activity to be authorised, if not already stated, and give relevant further details, for example (but not exclusively) whether or not music will be amplified or unamplified.
 5. For example (but not exclusively), where the activity will occur on additional days during the summer months.
 6. For example (but not exclusively), where you wish the activity to go on longer on a particular day e.g. Christmas Eve.
 7. Please give timings in 24 hour clock (e.g. 16.00) and only give details for the days of the week when you intend the premises to be used for the activity.
 8. If you wish people to be able to consume alcohol on the premises, please tick 'on the premises'. If you wish people to be able to purchase alcohol to consume away from the premises, please tick 'off the premises'. If you wish people to be able to do both, please tick 'both'.
 9. Please give information about anything intended to occur at the premises or ancillary to the use of the premises which may give rise to concern in respect of children, regardless of whether you intend children to have access to the premises, for example (but not exclusively) nudity or semi-nudity, films for restricted age groups or the presence of gaming machines.
 10. Please list here steps you will take to promote all four licensing objectives together.
 11. The application form must be signed.
 12. An applicant's agent (for example solicitor) may sign the form on their behalf provided that they have actual authority to do so.
 13. Where there is more than one applicant, each of the applicants or their respective agent must sign the application form.
 14. This is the address which we shall use to correspond with you about this application.

15. Entitlement to work/immigration status for individual applicants and applications from partnerships which are not limited liability partnerships:

A licence may not be held by an individual or an individual in a partnership who is resident in the UK who:

- does not have the right to live and work in the UK; or
- is subject to a condition preventing him or her from doing work relating to the carrying on of a licensable activity.

Any premises licence issued in respect of an application made on or after 6 April 2017 will become invalid if the holder ceases to be entitled to work in the UK.

Applicants must demonstrate that they have an entitlement to work in the UK and are not subject to a condition preventing them from doing work relating to the carrying on of a

licensable activity. They do this by providing with this application copies or scanned copies of the following documents (which do not need to be certified).

Documents which demonstrate entitlement to work in the UK

- An expired or current passport showing the holder, or a person named in the passport as the child of the holder, is a British citizen or a citizen of the UK and Colonies having the right of abode in the UK [please see note below about which sections of the passport to copy].
- An expired or current passport or national identity card showing the holder, or a person named in the passport as the child of the holder, is a national of a European Economic Area country or Switzerland.
- A Registration Certificate or document certifying permanent residence issued by the Home Office to a national of a European Economic Area country or Switzerland.
- A Permanent Residence Card issued by the Home Office to the family member of a national of a European Economic Area country or Switzerland.
- A **current** Biometric Immigration Document (Biometric Residence Permit) issued by the Home Office to the holder indicating that the person named is allowed to stay indefinitely in the UK, or has no time limit on their stay in the UK.
- A **current** passport endorsed to show that the holder is exempt from immigration control, is allowed to stay indefinitely in the UK, has the right of abode in the UK, or has no time limit on their stay in the UK.
- A **current** Immigration Status Document issued by the Home Office to the holder with an endorsement indicating that the named person is allowed to stay indefinitely in the UK or has no time limit on their stay in the UK, **when produced in combination with** an official document giving the person's permanent National Insurance number and their name issued by a Government agency or a previous employer.
- A **full** birth or adoption certificate issued in the UK which includes the name(s) of at least one of the holder's parents or adoptive parents, **when produced in combination with** an official document giving the person's permanent National Insurance number and their name issued by a Government agency or a previous employer.
- A birth or adoption certificate issued in the Channel Islands, the Isle of Man or Ireland **when produced in combination with** an official document giving the person's permanent National Insurance number and their name issued by a Government agency or a previous employer.
- A certificate of registration or naturalisation as a British citizen, **when produced in combination with** an official document giving the person's permanent National Insurance number and their name issued by a Government agency or a previous employer.
- A **current** passport endorsed to show that the holder is allowed to stay in the UK and is currently allowed to work and is not subject to a condition preventing the holder from doing work relating to the carrying on of a licensable activity.

- A **current** Biometric Immigration Document (Biometric Residence Permit) issued by the Home Office to the holder which indicates that the named person can currently stay in the UK and is allowed to work relation to the carrying on of a licensable activity.
- A **current** Residence Card issued by the Home Office to a person who is not a national of a European Economic Area state or Switzerland but who is a family member of such a national or who has derivative rights or residence.
- A **current** Immigration Status Document containing a photograph issued by the Home Office to the holder with an endorsement indicating that the named person may stay in the UK, and is allowed to work and is not subject to a condition preventing the holder from doing work relating to the carrying on of a licensable activity **when produced in combination with** an official document giving the person's permanent National Insurance number and their name issued by a Government agency or a previous employer.
- A Certificate of Application, **less than 6 months old**, issued by the Home Office under regulation 17(3) or 18A (2) of the Immigration (European Economic Area) Regulations 2006, to a person who is not a national of a European Economic Area state or Switzerland but who is a family member of such a national or who has derivative rights of residence.
- Reasonable evidence that the person has an outstanding application to vary their permission to be in the UK with the Home Office such as the Home Office acknowledgement letter or proof of postage evidence, or reasonable evidence that the person has an appeal or administrative review pending on an immigration decision, such as an appeal or administrative review reference number.
- Reasonable evidence that a person who is not a national of a European Economic Area state or Switzerland but who is a family member of such a national or who has derivative rights of residence in exercising treaty rights in the UK including:-
 - evidence of the applicant's own identity – such as a passport,
 - evidence of their relationship with the European Economic Area family member – e.g. a marriage certificate, civil partnership certificate or birth certificate, and
 - evidence that the European Economic Area national has a right of permanent residence in the UK or is one of the following if they have been in the UK for more than 3 months:
 - (i) working e.g. employment contract, wage slips, letter from the employer,
 - (ii) self-employed e.g. contracts, invoices, or audited accounts with a bank,
 - (iii) studying e.g. letter from the school, college or university and evidence of sufficient funds; or
 - (iv) self-sufficient e.g. bank statements.

Family members of European Economic Area nationals who are studying or financially independent must also provide evidence that the European Economic Area national and any family members hold comprehensive sickness insurance in the UK. This can include a private medical insurance policy, an EHIC card or an S1, S2 or S3 form.

Original documents must not be sent to licensing authorities. If the document copied is a passport, a copy of the following pages should be provided:-

- (i) any page containing the holder's personal details including nationality;

- (ii) any page containing the holder's photograph;
- (iii) any page containing the holder's signature;
- (iv) any page containing the date of expiry; and
- (v) any page containing information indicating the holder has permission to enter or remain in the UK and is permitted to work.

If the document is not a passport, a copy of the whole document should be provided.

Your right to work will be checked as part of your licensing application and this could involve us checking your immigration status with the Home Office. We may otherwise share information with the Home Office. Your licence application will not be determined until you have complied with this guidance.

IMPRP: 1 cm

 Proposed Alcohol Display Area

☐ - LICENSIBLE AREA

F - Fire Extingisher

X - camera points

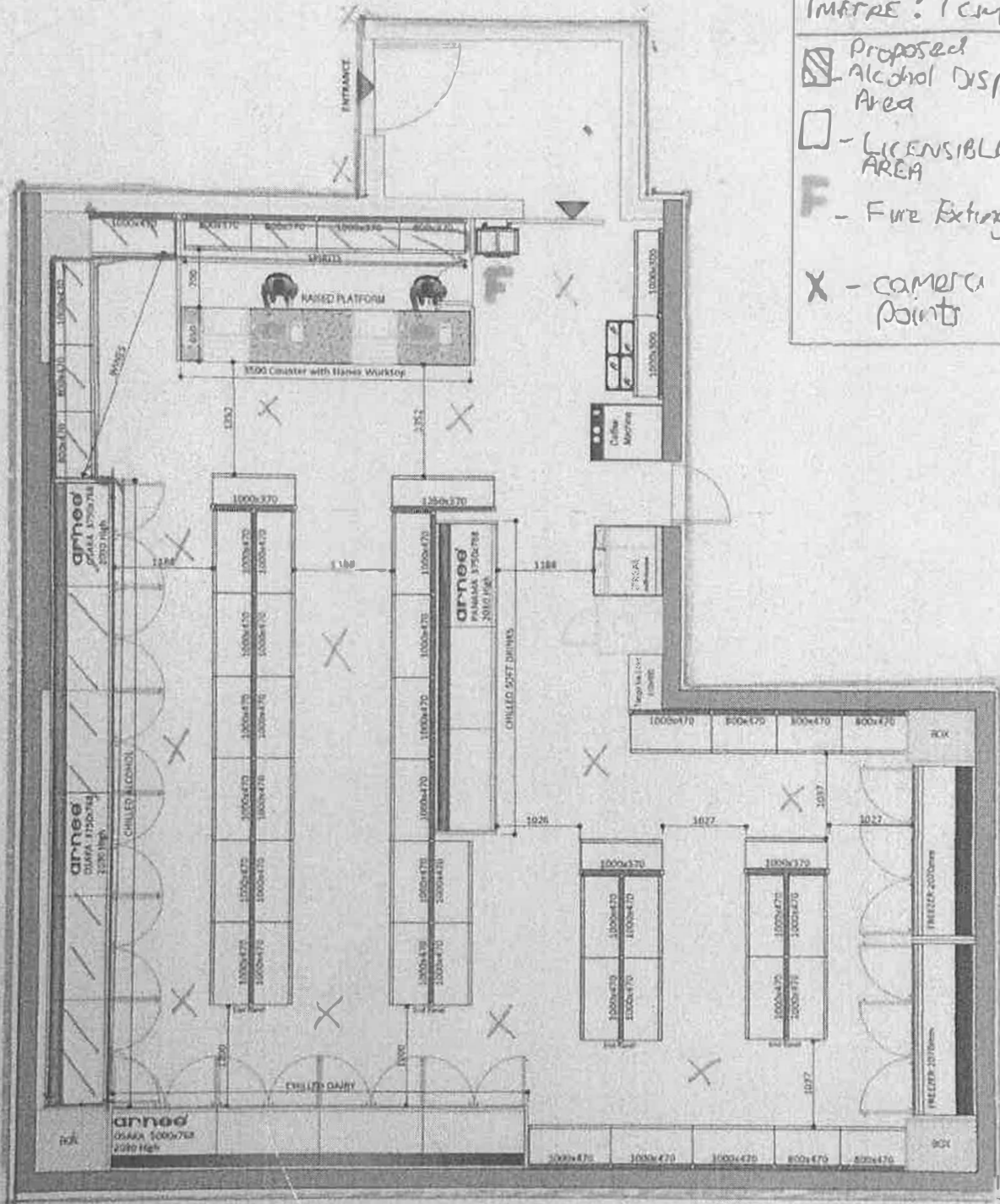

The information contained within this document is the sole property of NRC. It is not to be copied, reproduced, or disseminated without the express written permission of the NRC. It is to be used for official purposes only.



Shoplifter

9 OFFORD ROAD, HARROW
MIDDLESEX HA3 6PN

Spar
Castle Donington

DRAWING TITLE: Proposed Plan

1990

100

JOHN A.

PROFESSOR MURPHY, 1971

GENERAL NOTES:

It is... me - and he checked on who
the other students are
He thought they were all students
he was not a student

This page is intentionally left blank



Appendix 3

This page is intentionally left blank

Appendix 4

Dovecote
Veterinary Hospital

SPAR

Castle Donington
Town Bowls Club

db's Serviced Apar
- The l

This page is intentionally left blank

**NORTH WEST LEICESTERSHIRE DISTRICT COUNCIL
LICENSING ACT 2003**

REPRESENTATION FORM

Appendix 5

Your name/organisation name/name of body you represent	Dianne Robey
Organisation name/name of body you represent (if appropriate)	Castle Donington Town Bowls Club
Your Postal address	
Name of the premises you are making a representation about	Proposed SPAR Shop
Address of the premises you are making a representation about	Delven Lane, Castle Donington, Derby

What are you making a representation about?
Please indicate which part of the licence/certificate application you are making a representation about (i.e. Terminal hours, and music and dancing on Friday and Saturday night)
Licence to sell alcohol

Your representation must relate to one of the four Licensing Objectives

Licensing Objective	<i>Please provide full details of your concerns regarding the application and include any evidence you may have in support of it. Please use separate sheets if necessary</i>
To prevent crime and disorder	There is already anti-social gathering in that area and we are afraid that a licenced premises will only exacerbate this problem.
Public safety	We believe that there is already a drug taking problem around the surrounding business premises that cannot be seen from Delven Lane and feel that this anti-social situation will increase if the sale and consumption of alcohol in this locality is not avoided.
To prevent public nuisance	The shop will be surrounded by business premises which have very little evening use and fear very much that damage can be caused to these unprotected properties by anti-social personnel. The above premises have private car park facilities therefore a limited amount of street parking is all that is available.
To protect children from harm	

Please suggest any conditions that could be added to the licence to remedy your representation or other suggestions you would like the Licensing Sub Committee to take into account.	Visits to this locality by law enforcement officers is currently minimal, a vastly increased presence could help the situation but will certainly not eradicate the anti-social element of property damage and disorder that will undoubtedly occur
---	--

Signed: D Robey

Date: 31st August 2021

Capacity: Secretary Castle Donington Town Bowls Club

NOT FOR PUBLICATION

Your e-mail address	
Your contact telephone number	

SUPPORTING NOTES

If you do make a representation you will be invited to attend a meeting of the Licensing sub Committee and any subsequent appeal proceeding. If you do not attend, the Committee will consider any representations that you have made.

This form must be returned within the Statutory Period, which is 28 days from the date the notice was displayed on the premises or the date specified in the Public Notice in the newspaper. Please contact the Licensing Section on 01530 454556 if you are in doubt about the date.

They can only relate to the four licensing objectives.

Your representation will be passed to the applicant, to allow them the opportunity of addressing your concerns. Your representations will be published in the report available to the Licensing Sub-Committee, which will be publicly available. Names and addresses will only be withheld from the Sub-Committee report at your request. Email addresses and contact telephone numbers will not be publicly available.

Please return this form when completed along with any additional sheets to:

Community Services
Licensing
North West Leicestershire District Council
Council Offices
Coalville
Leicestershire
LE67 3FJ

email to licensing@nwleicestershire.gov.uk

Tel: 01530 454545
Fax: 01530 454574



26th August 2021

North West Leicestershire District Council,
Whitwick Road,
Coalville,
Leicestershire,
LE6 3FJ

Dear Sir or Madam,

Re: Spar Castle Donington, Delven Lane, Castle Donington, DE74 2LJ

I am Chairman of Castle Donington Town Bowls Club whose premises are adjacent to the ex Library, now apparently a Spar shop.

I note the notice advising of the application for a Premises Licence and wish to register my objections on behalf of the Bowls Club.

Firstly we have not, as neighbours, received any planning notice nor have seen a planning notice displayed at the premises, advising an application for change of use from a Library to a Shop and therefore conclude that the premises are still a Library. This being so I object to a Library selling alcohol.

Secondly, we already suffer litter from the younger elements of the area using our car park as a dining area and leaving behind their litter. Should a shop be approved and granted an alcohol Premises Licence this can only compound our current problems.

We are not able to fence off and gate our car park as the Territorial Army use the hut accessed through our car park and we in turn have access rights across the veterinary hospital car park so they cannot gate their car park as they have to give us and the T A access.

The village already has five shops selling alcohol, will soon have a sixth as well as a variety of food outlets that sell alcohol and a multiplicity of public houses , hotels and clubs, so an additional alcohol selling outlet is simply not required.

I trust this application will be refused.

Yours faithfully,

Paul Clewett



This page is intentionally left blank

**NORTH WEST LEICESTERSHIRE DISTRICT COUNCIL
LICENSING ACT 2003**

Appendix 7

REPRESENTATION FORM

Your name/organisation name/name of body you represent	CVS (UK) Limited CVS House, Owen Road, Diss Norfolk IP22 4ER
Organisation name/name of body you represent (if appropriate)	
Your Postal address	IP22 4ER
Name of the premises you are making a representation about	Dovecote Veterinary Hospital
Address of the premises you are making a representation about	5 Delven Ln, Castle Donington, Derby DE74 2LJ

What are you making a representation about?
Please indicate which part of the licence/certificate application you are making a representation about (i.e. Terminal hours, and music and dancing on Friday and Saturday night)
LICENSE APPLICATION REFERENCE: 21/00471/PREM - SPAR, DELVEN LANE, CASTLE DONINGTON, DERBY, DE74 2LJ
The licence as a whole.

Your representation must relate to one of the four Licensing Objectives

Licensing Objective	<i>Please provide full details of your concerns regarding the application and include any evidence you may have in support of it. Please use separate sheets if necessary</i>
To prevent crime and disorder	Please see attached letter
Public safety	Please see attached letter
To prevent public nuisance	Please see attached letter
To protect children from harm	Please see attached letter.

Please suggest any conditions that could be added to the licence to remedy your representation or other suggestions you would like the Licensing Sub Committee to take into account.	None.
---	--------------

Signed:

Wafaa Syed

Date: **24th August 2021**

NOT FOR PUBLICATION

Your e-mail address	
Your contact telephone number	

SUPPORTING NOTES

If you do make a representation you will be invited to attend a meeting of the Licensing sub Committee and any subsequent appeal proceeding. If you do not attend, the Committee will consider any representations that you have made.

This form must be returned within the Statutory Period, which is 28 days from the date the notice was displayed on the premises or the date specified in the Public Notice in the newspaper. Please contact the Licensing Section on 01530 454556 if you are in doubt about the date.

They can only relate to the four licensing objectives.

Your representation will be passed to the applicant, to allow them the opportunity of addressing your concerns. Your representations will be published in the report available to the Licensing Sub-Committee, which will be publicly available. Names and addresses will only be withheld from the Sub-Committee report at your request. Email addresses and contact telephone numbers will not be publicly available.

Please return this form when completed along with any additional sheets to:

Community Services
Licensing
North West Leicestershire District Council
Council Offices
Coalville
Leicestershire
LE67 3FJ

Email to licensing@nwleicestershire.gov.uk

Tel: 01530 454545
Fax: 01530 454574

The Licensing Section
North West Leicestershire District Council
Council Offices
Coalville
Leicestershire
LE67 3FJ

Appendix 8

Our ref: 235/WS/Dovecote Veterinary Hospital
Your ref: 21/00471/PREM

24th August 2021

Dear Sirs

**Re: LICENSE APPLICATION REFERENCE: 21/00471/PREM - SPAR, DELVEN LANE, CASTLE
DONINGTON, DERBY, DE74 2LJ**

We write in relation to the above alcohol license submitted on the 3rd August 2021 for the above premises.

CVS vets (trading at Dovecote Veterinary Hospital) occupy the adjacent premise. We reviewed the application Notice and wish to object to such a licence being granted for the following reasons:

1. We understand the premises is a Library and is registered under use class F1 d. We are of the view that the sale of alcohol within a library is not in the public's best interests and there will be a high risk of public nuisance. Such a license will not be suitable for such a setting especially where minors are likely to attend.
2. In the event the license is granted, we are concerned there will be an influx of intoxicated individuals making use of the surrounding parking and driving vehicles while intoxicated, and therefore causing a risk to public safety, especially to our staff and clients.
3. Individuals will have to park on the Road or pavement to access the library; this will cause a public safety issue.
4. The alcohol licence would increase the number of intoxicated individuals and therefore result in a risk of the hospital being broken into as there are dangerous drugs being stored on site. This is a risk of harm to the public and the cause of public nuisance.

In respect of the above, we are very concerned about the potential grant of the licence and strongly request the application to be reviewed and disregarded.



We look forward to hearing from you.

CVS (UK) LTD

Legal Department

CVS House

Owen Road

Diss

IP22 4ER

T: 01379 644288

F: 01379 447903

E: legal@cvsvets.com

W: www.cvsukltd.co.uk

Yours faithfully

Wafaa Syed

In-house Solicitor

CVS (UK) Limited

Wafaa.Syed@cvsvets.com

Environmental Health

Licensing

Please ask for: Paul Dennis

Telephone: 01530 454596

Fax: 01530 454574

Our Ref: 21/00471/PREM

Your Ref: 235/WS/Dovecote Veterinary
Hospital

Date: 17 September 2021

Wafaa Syed
CVS (UK) Limited
Legal Department
CVS HouseOwen Road
Diss
IP22 4ER

Dear Sir/Madam,

**LICENSING ACT 2003 – GRANT NEW PREMISES LICENCE
THE SPAR, DELVEN LANE, CASTLE DONINGTON, DE74 2LJ**

Thank you for your e-mail and representation concerning the above application. Please accept this letter as acknowledgement of your representation. Unfortunately, in this instance, your representation is not considered relevant and is therefore rejected. The reason for rejection is as follows:-

We understand the premises is a Library and is registered under use class F1 d. We are of the view that the sale of alcohol within a library is not in the publics best interests and there will be a high risk of public nuisance. Such a license will not be suitable for such a setting especially where minors are likely to attend.

All Planning issues are dealt with under the Town and Country Planning Act 1990 and not under the Licensing Act, so this is not relevant with regard to this application. However the premises was a library. It is not a library anymore. I understand the applicant has been in touch with the planning department and an application is being submitted. Of course they will have to change the planning permissions to operate as a shop. However this has nothing to do with this application or the licensing act objectives, so it would not concern this application. I can confirm the sale of alcohol will not take place within a library, where minors are likely to attend.

In the event the license is granted, we are concerned there will be an influx of intoxicated individuals making use of the surrounding parking and driving vehicles while intoxicated, and therefore causing a risk to public safety, especially to our staff and clients. Individuals will have to park on the Road or pavement to access the library; this will cause a public safety issue.

Parking issues are covered under the Highways Act 1980 and are not a matter for the Licensing Act, this is therefore not relevant with regard to this application. If you wish to discuss parking issues, please contact Highways at Leicestershire County Council

The alcohol licence would increase the number of intoxicated individuals and therefore result in a risk of the hospital being broken into as there are dangerous drugs being stored on site. This is a risk of harm to the public and the cause of public nuisance.

The application is for a shop with “off-sales” only and not for a bar with “on sales”. Therefore it is highly unlikely there will be “increased numbers of intoxicated individuals” in the area due to a shop opening. We also have numerous veterinary surgeons within the North West Leicestershire District which are close to shops and bars and I am not aware of these veterinary hospitals being broken into by intoxicated individuals, as a result of having a local shop selling alcohol.

As a result, this representation cannot be considered as relevant, as there is no evidence of “cause to public safety”, “an increased number in intoxicated people”, “public nuisance” or “break-ins at veterinary hospitals”. However, should you have evidence of cause to public safety, an increase in intoxicated people, public nuisance or break-ins into your hospital, please feel free to submit a further representation with this evidence attached (before the end of representations deadline on 31 August 2021) and it will be given every consideration by the licensing Sub-Committee.

Should the licence be issued and as a result, the issues you mention above do materialise, there is an option within the Licensing Act for you to call a review of the licence. If there is evidence of these issues demonstrated at the review, the licence could be revoked or amended, so there are measures in place going forward within the Licensing Act. However at this stage, the issues you mention are merely speculation of a worse-case scenarios and cannot be considered, as they may never occur.

Please feel free to contact me if you wish to discuss this further.

Yours Sincerely,

Paul Dennis
Licensing Enforcement Officer

Environmental Health

Licensing

Please ask for: Paul Dennis

Telephone: 01530 454596

Fax: 01530 454574

Our Ref: NWL20555

Date: 17 September 2021

Mr P Clewett
52A The Spital
Castle Donington
Derbyshire
DE74 2NQ

Dear Mr Clewett,

**LICENSING ACT 2003 – GRANT NEW PREMISES LICENCE
THE SPAR, DELVEN LANE, CASTLE DONINGTON, DE74 2LJ**

Thank you for your letter and representation concerning the above application. Please accept this letter as acknowledgement of your representation. Unfortunately, in this instance, your representation is not considered relevant and is therefore rejected. The reason for rejection is it is not relevant to the 4 Licensing Act objectives which are public nuisance, public safety, prevention of crime and disorder and protection of children from harm.

All Planning issues are dealt with under the Town and Country Planning Act 1990 and not under the Licensing Act, so this is not relevant with regard to this application. However the premises was a library. It is not a library anymore. I understand the applicant has been in touch with the planning department and an application is being submitted. Of course they will have to change the planning permissions to operate as a shop. However, this has nothing to do with this application or the licensing act objectives, so it would not concern this application.

Parking issues are covered under the Highways Act 1980 and are not a matter for the Licensing Act, this is therefore not relevant with regard to this application. If you wish to discuss parking issues, please contact Highways at Leicestershire County Council. Existing litter issues in your car park cannot be considered before a premises has even opened.

As a result, this representation cannot be considered as relevant, as there is no evidence with regard to the 4 licensing objectives. However, should you have evidence with regard to this premises and with regard to the Licensing Act's 4 objectives, please feel free to submit a further representation with this evidence attached (before the end of representations deadline on 31 August 2021) and it will be given every consideration by the licensing Sub-Committee.

Should the licence be issued and as a result, any issues do materialise, there is an option within the Licensing Act for you to call a review of the licence. If there is evidence of these issues demonstrated at the review, the licence could be revoked or amended, so there are measures in place going forward within the Licensing Act. However at this stage, the issues you mention cannot be considered.

Please feel free to contact me if you wish to discuss this further.

Yours Sincerely,

Paul Dennis
Licensing Enforcement Officer

This page is intentionally left blank